

## Opening Hours | Admission Prices

Every Sunday 2:00 pm – 5:00 pm (closed between December 1st and January 26th).  
Group tours can be arranged at any time, even during our winter break.

**Single Entry:** 3.50 €, reduced 1.50 €  
**Groups** (from 7 people): 2.50 €/pers., reduced 1.50 €/pers.  
**plus Guide:** 25.00 €, reduced 10.00 €  
**Projects for students:** Half-day – 20.00 € / Full-day – 40.00 €  
Reduction for members, students and trainees.

## For your information

Publications are available in the little shop at the cash. Further information can be found on our website: [www.kz-denk-neckarelz.de](http://www.kz-denk-neckarelz.de)  
In order to arrange the perfect tour for your group, please ensure that you register your group visit as early as possible.

## Thank you for your donation!

Spk. Neckartal-Odenwald / IBAN: DE23 6745 0048 0003 6885 95 / BIC: SOLADES1MOS  
Volksbank Mosbach / IBAN: DE04 6746 0041 0020 9107 04 / BIC: GENODE61MOS

## Masthead

© 2018 **KZ-Gedenkstätte Neckarelz e.V.**  
**Mosbacher Straße 39 | D-74821 Mosbach**  
**Tel. ++49.6261.670653 | Fax ++49.6261.672381**  
**Email: [vorstand@kz-denk-neckarelz.de](mailto:vorstand@kz-denk-neckarelz.de) | [www.kz-denk-neckarelz.de](http://www.kz-denk-neckarelz.de)**



This flyer was funded through the Baden Wuerttemberg Center for Political Education.



Photos: U. Thiele, T. Krieger, NARA, U. Boll, M. Piet, G. Fischer / Design: Ch. Schneider, bauwerk-design.de / Printing: Metzgerdruck Obrigheim

## 1944/45 – GOLDFISH – ZEBRA – NECKAR CONCENTRATION CAMP COMPLEX

END OF FEBRUARY / BEGINNING OF MARCH 1944

Allied bombers heavily attack the German Armament Industry. The Nazi leaders found the “Jägerstab” in Berlin, in order to ensure the production of fighter planes. The Daimler-Benz Airplane Motor Factory in Genshagen near Berlin is badly damaged. The “Jägerstab” decides to transfer important parts of the factory to the gypsum mines near Obrigheim. The SS provides concentration camp prisoners for the construction work. The code names for this project are “A8” and “Goldfish”

MID-MARCH TO JULY 1944 | In mid-March, the first 5,000 concentration camp prisoners are accommodated in the Neckarelz Elementary School. The establishment of more new barracks follows. On April 26, the Neckargerach concentration camp is opened for over 1,000 prisoners. On July 23, a second, equally large camp opens in Neckarelz (near the old train station). In total, over 5,000 prisoners – known as zebras because of their striped clothes – are forced to work and live in the area under primitive conditions.

END OF JUNE 1944 | The relocation of the machines in the underground armament factory “Goldfish” begins. This includes the mostly involuntary relocation of approximately 5,000 Daimler-Benz Genshagen factory workers. The concentration camp prisoners construct the camp for the Daimler-Benz forced laborers.

DURING FALL 1944 | The three smaller concentration camp annex camps, Asbach, Neckarbischofsheim and Bad Rappenau become part of the Neckar Concentration Camp complex. The 10,000 prisoners that are forced to work for the “Goldfish” project represent more than 25 nations.

END OF MARCH 1945 | The concentration camps, the factory and forced labor camps are dissolved. The strenuous work for the armament industry in the Neckar concentration camp complex is marked by SS terror, hunger, disease and many, many victims: almost 300 people die in the area. If you include those who die while being relocated to other camps, during the evacuation, or shortly after the liberation, then 1,500 Neckar camp prisoners never return home.

For many years, these events were never talked about.

## CONCEPT

The first floor houses the exhibitions NECKAR CAMP CONCENTRATION CAMP COMPLEX and OPEN SPACE, and is level with the schoolyard. Wooden slats characterize the building. The effects of the weather have darkened the slats, making us think of the zebra stripes of the prisoners’ clothing. At the same time, the slats resemble a modern digital code. A parallel to the present digital transparency is intended. The boundaries between inside and outside, past and present are diaphanously emphasized by the slats. They help to gain insight, and perhaps even some perspective of the events that took place here.

The “GOLDFISH” and NATZWEILER ON THE NECAKR rooms are located in the basement of the memorial. The long concealed causes and effects are clarified. The production of armaments by the “Goldfish” company was the reason for the setting up of the concentration camp complex. The administration of the prisoners was done from the Natzweiler main camp. The administration would later be divided amongst the annex camps along the Neckar. The exhibition enables visitors to discover history for themselves. The objects and rooms offer impulses for personal reflection. Further information is available in the drawers beneath each display. The archives allow for even deeper research.

## GOALS OF THE NECKARELZ CONCENTRATION CAMP MEMORIAL ASSOCIATION

The association carries out both the organizational and historical work of the Concentration Camp Memorial. It maintains the contact between former prisoners, their families, and organizations in many countries. It is connected to numerous memorials, schools and other educational institutions. They are actively confronting any right wing extremist and racist threats. Through various events, they ensure that the tyranny and persecution of the National Socialists, as well as the resistance in the region will never be forgotten.



2018 awarded in the European Heritage Label





**THE NECKAR CONCENTRATION CAMP COMPLEX** | Moveable figures reflect the camp community and allow for glimpses into the network of relationships. Next to the large window, you can discover the prisoners' life stories by using their prison numbers. Various aspects of concentration camp life are represented either symbolically, through cards or drawings, or through original objects displayed in the showcases. The obstructed view through the vertical blinds allows you to see "outside", and creates the connection to this historical site. Additional information can be found in the drawers below the displayed objects.

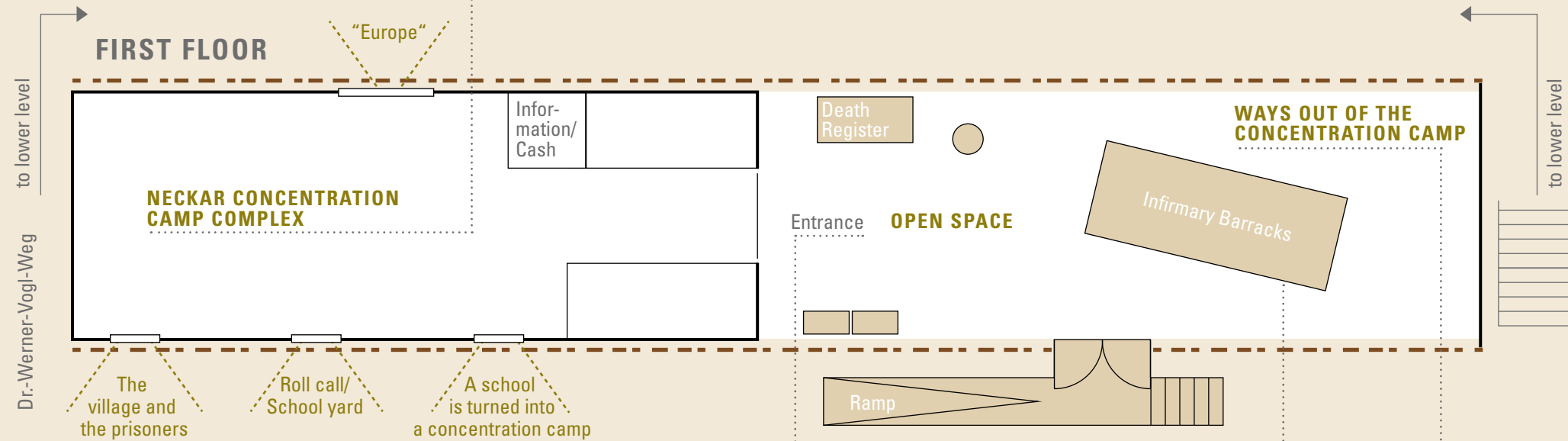

**OPEN SPACE** | Although it has a roof, the OPEN SPACE is enclosed solely by a curtain of vertical blinds, and thus allows the outside temperatures to fill the room. On the way to the NECKAR CONCENTRATION CAMP COMPLEX room, the visitor is introduced to the exhibition through historical information and a mirror installation. The re-established infirmary barracks is located in the center of the room. The death register and the three panels on the eastern wall represent the topic WAYS OUT OF THE CAMP.



**NATZWEILER ON THE NECKAR** | The Neckar concentration camps were administered by the main camp of Natzweiler-Struthof, located in the Vosges, 50 km west of Strasbourg. Beginning in September 1944, Natzweiler and the annex concentration camps west of the Rhine were evacuated. This eastward shift meant that the prisoners now had to work in the camps east of the Rhine. In late fall 1944, the SS relocated the administration and command of the main camp to Guttenbach, Binau and Neunkirchen. Maps and moveable boards illustrate this process. An interactive terminal enables our visitors to research the names of prisoners of both the main and annex camps.

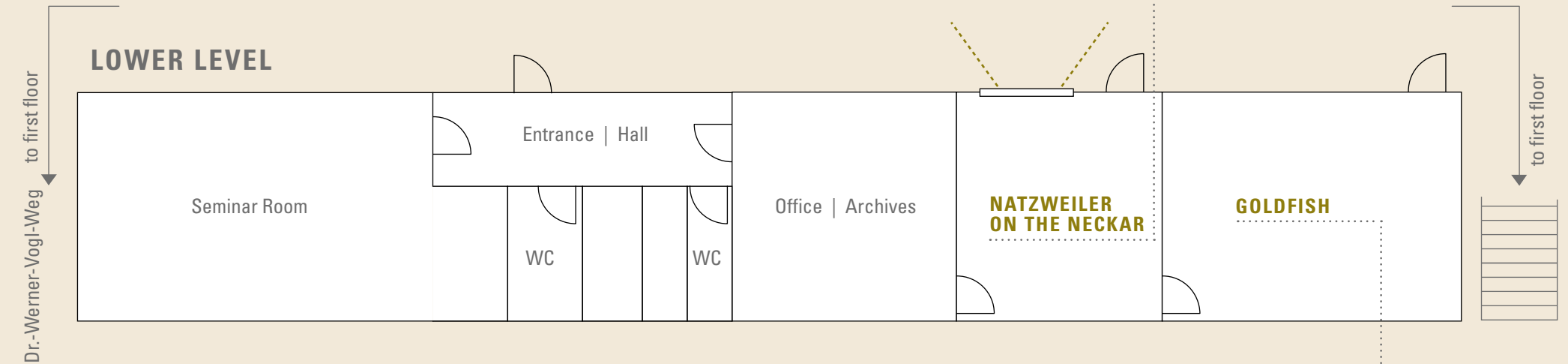

**GOLDFISH** | Under the supervision of the SS, and with the help of state and local authorities, the 5,000 concentration camp prisoners, now construction slaves, were able to transform the Obrigheim gypsum mines into a modern airplane motor factory in five months. An additional 5,000 men and women (for the most part involuntarily) worked in the mines under horrible conditions. In order to ensure that certain machines didn't fall into the hands of the Soviets, Daimler-Benz arranged for these machines to be stored in the mines, although they were unnecessary for the production of motors.

This room creates an atmosphere of secrecy, and of being underground. A railway track divides the room diagonally. The left side of the track shows the grueling slave work of the concentration camp construction prisoners being carried out with the simplest tools. On the right, the forced laborers of the "Loyal Followers", using the most modern machines of the time. The division of meals were similarly allocated amongst the two groups.

